

## Power II™ Inversion Table

Patent applies.

**Before you begin:** These instructions will guide you in properly assembling the unit. Please review all the steps before beginning assembly. Carefully adhere to the Assembly Instructions and Owner's Manual to help ensure user safety and product integrity.

### ⚠ WARNING

1. Failure to assemble and/or use the equipment as directed may void the manufacturer's warranty on this product and could result in injury or death.
2. It is your responsibility to familiarize yourself with the proper use of the equipment and the inherent risks of inversion, such as falling on your head or neck, pinching, entrapment or equipment failure.
3. Do not use the inversion table until you have thoroughly and carefully read the Owner's Manual, reviewed all other accompanying documents, and inspected the equipment.
4. Choose a level surface for assembling and operating the table.
5. Follow each step in sequence. Do not skip ahead.
6. Make sure that all fasteners are secure.
7. Prior to use, test and inspect the table to ensure smooth operation.
8. Refer to additional warning notices and information posted on the equipment.

Carefully remove the individual parts from the carton. You should have all of the items listed below. If any items are missing or damaged, contact your retailer or customer service directly (See reverse side).

#### ITEMS FOR ASSEMBLY

#### ITEM #'s

|                    |         |
|--------------------|---------|
| Bed frame assembly | P1-1000 |
| Chain with crank   | P1-5004 |
| Rear frame         | P1-1001 |
| Front frame        | P1-1002 |
| Main shaft         | P1-2100 |
| Locking knobs      | P1-1003 |
| Handles            | P1-1015 |

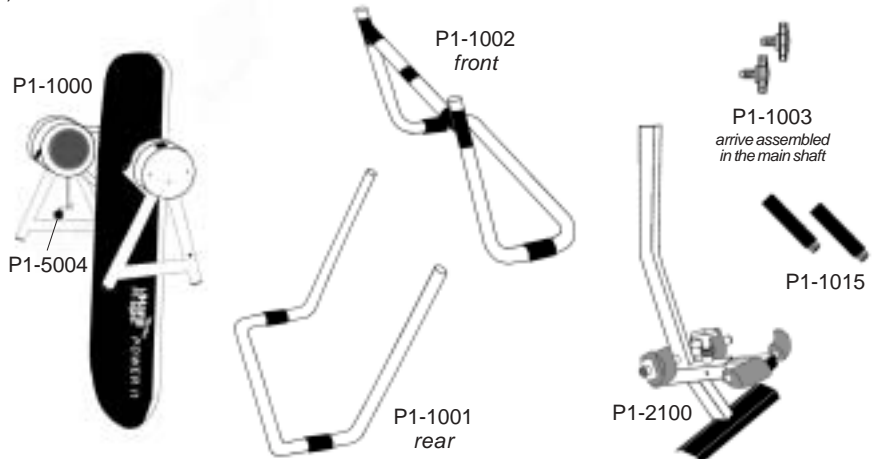

## ASSEMBLY

**Note:** The bed frame assembly arrives rotated into the fully inverted position. This is the most convenient position from which to begin the assembly process.

### STEP ONE

#### Secure rear frame (P1-1001) to bed frame assembly (P1-1000)

- Insert the rear frame into the bed frame assembly (the logo on the bed will be facing the rear). (See Figure 1) Make sure the spring-loaded locking pins on each leg pop through the holes.

### STEP TWO

#### Secure front frame (P1-1002) to bed frame assembly (P1-1000)

- Insert the front frame into the bed frame assembly. Make sure the spring-loaded locking pins on each leg pop through the holes.

### ⚠ WARNING

Ensure that the spring-loaded locking pins are attached securely and that the front and rear frames sit evenly on the floor. Improper assembly could result in serious injury or death.

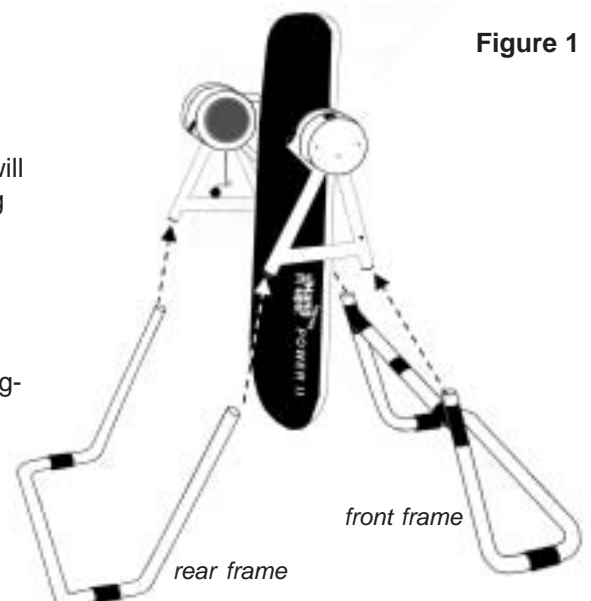

Figure 1

# ASSEMBLY

## STEP THREE

### Secure main shaft (P1-2100) to bed frame assembly (P1-1000)

- Remove the locking knobs (P1-1003) from the holes in the main shaft (they are pre-assembled for shipping purposes).
- Insert the main shaft into the bed frame assembly. (See Figure 2)
- Line up the holes on the back of the bed with those on the main shaft. Insert and tighten both locking knobs to secure the main shaft to the bed frame assembly.



Figure 2

Figure 3



## STEP FOUR

### Secure handles (P1-1015) to bed frame assembly (P1-1000)

- Insert and tighten the handles into the arms on both sides of the bed frame assembly. (See Figure 3)

## STEP FIVE

### Connect cord to the power source

- Connect the cord to your power source\* and rotate the bed upright using the power control switch. Make sure the table operates smoothly.

#### \* GROUNDING INSTRUCTIONS

This product must be grounded. If it should malfunction or breakdown, grounding provides a path of least resistance for electric current to reduce the risk of electric shock. This product is equipped with a cord having an equipment-grounding conductor and a grounding plug. The plug must be plugged into an appropriate outlet that is properly installed and grounded in accordance with all local codes and ordinances. **DANGER** - Improper connection of the equipment-grounding conductor can result in a risk of electric shock. Check with a qualified electrician or serviceman if you are in doubt as to whether the product is properly grounded. Do not modify the plug provided with the product - if it will not fit the outlet, have a proper outlet installed by a qualified electrician.

Figure 4

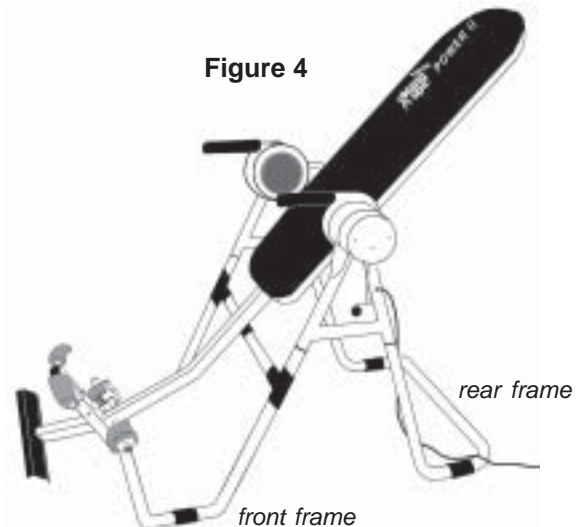

### You are finished assembling your Power II™ Inversion Table. Please remember:

- Read your Owner's Manual thoroughly before using the inversion table.
- Test the table for smooth and steady rotation before inverting.
- For your reference, the table's serial number can be found on a sticker mounted to the motor housing.
- Please complete and mail your warranty card, or submit it on-line at [www.TeeterHangUps.com](http://www.TeeterHangUps.com).



Patent applies.

Teeter Hang Ups® is a registered trademark of STL Inc. and Inversion International, Ltd. Specifications subject to change without notice.

©COPYRIGHT 2004, STL Inc. and Inversion International, Ltd.

International Law Prohibits Any Copying, 01/04-1

For information about the Teeter Hang Ups® 2-year warranty, or if you have any problems assembling the equipment or questions about its use, please contact Customer Service at the appropriate location below:

#### USA & Canada:

STL Inc.

9902 162<sup>nd</sup> St. Ct. E., Puyallup, WA 98375

Toll Free (Phone) 800-847-0143 (Fax) 800-847-0188

Local (Phone) 253-840-5252 (Fax) 253-840-5757

(email) [Info26@TeeterHangUps.com](mailto:Info26@TeeterHangUps.com)

(web) [www.TeeterHangUps.com](http://www.TeeterHangUps.com)

#### International:

Inversion International, Ltd.

PO Box: AP 59245, New Providence Island, Bahamas

(Phone) +1-242-362-1001

(Fax) +1-242-362-1002

(email) [Info@InversionInternational.com](mailto:Info@InversionInternational.com)

(web) [www.InversionInternational.com](http://www.InversionInternational.com)